

# PR 106 Room

Located upper level of Exhibit Hall.

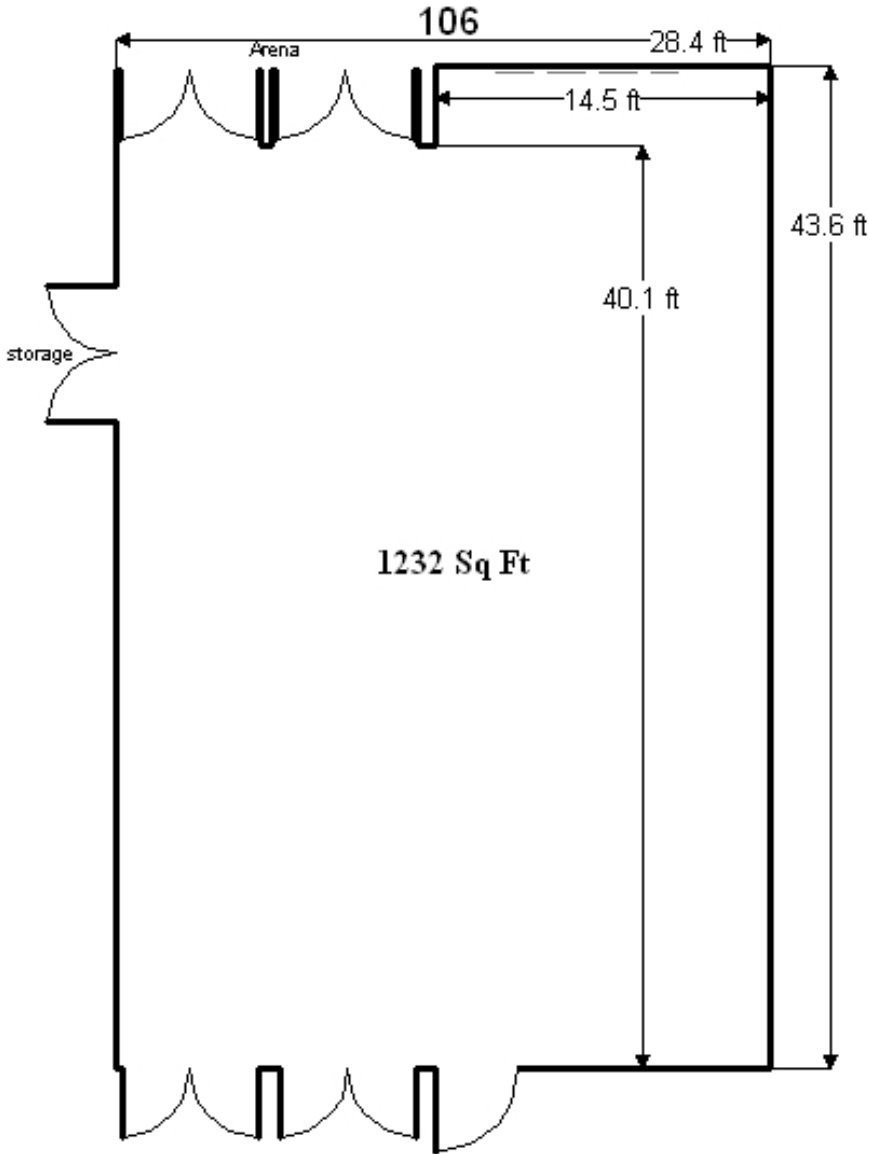

### AV Options:

\*AV equipment may be provided at an additional fee, price list can be provided by request

Secured Hard-line Internet

Free Unsecured WiFi

Cable

Phone

Portable Sound

### Room Capacities

\*This is our recommended capacities to maintain fire code for aisle and entries

Classroom: 66ppl

Theater: 119ppl

Banquet: 72ppl

U-Shape: 31ppl

Box Set: 38ppl

