

stay in the loop

KWA newsletter

King William Association

Volume 12, No. 6

July 2016

Energy Retrofits for Historic Homes

Historic homes, because of their age and condition, offer considerable potential for energy retrofits that can reduce their energy use and utility costs as well as improve living conditions for their owners. However, few reliable studies are available to inform the owners of historic homes in hot and humid regions as to appropriate retrofits for their homes, and none offer any prioritization of these potential retrofits. Such guidance is needed both to ensure that the retrofits are appropriate for older homes and, more importantly, that they meet the requirements typically placed on these historic homes and do not impact their cultural value.

To address this, a team of researchers from UTSA's Center for Cultural Sustainability (CCS) has conducted a study to identify and prioritize cost-effective retrofits for historic homes in hot and humid regions. This interdisciplinary team was led by Professor William Dupont, CCS director, and included Professors Hazem Rashed-Ali, Randy Manteufel and Thomas Thomson. Graduate student Levi Sanciu contributed as well.

The team analyzed four homes in San Antonio dating to the beginning of the 20th century and all located in historic districts. Through conducting detailed measure-

ments, assessments of physical conditions, infrared thermography, and performance simulation, the team identi-



1904 Victorian style house on Daniel Street, with characteristics of the houses included in the UTSA study.

fied a series of retrofits that offered the most energy savings and economic potential for homeowners, while not impacting the historic character of the homes. Primary retrofits recommended by the study include attic insulation, sealing of HVAC ducts, radiant barriers, weather stripping and attic ventilation.

Some retrofits were not recommended because of their long payback periods, their potential impact on the home's historic character, or both. These

include window replacement, storm windows, and adding wall insulation or a vapor retarder.

In another significant finding, the study found that within the San Antonio real estate market, old homes with at least one green upgrade sell approximately 10 percent higher than identical homes without such upgrades.

In a second phase of the project, Dupont and colleagues are currently evaluating radiant barriers as a potential retrofit for historic homes in hot, humid regions. The project, funded by the National Center for Preservation Technology and Training (NCPTT), involves retrofitting the attics of up to 10 historic homes with radi-

Continued on page 9

President's Report

by Harry Shafer

There is a continued commercial development trend going on along the S. Alamo corridor. Two major commercial properties, the former vending machine warehouse at 1811 S. Alamo and an adjacent tract at 1302 S. Flores, were purchased by David Adelman. The S. Alamo property is scheduled for mixed-use with creative office space, plus a restaurant and/or bar. The King William Association has been following the process through HDRC and Zoning, and formally requested that no outdoor amplified music be allowed. The Zoning Commission approved the IDZ zoning with C2 and Bar uses without restricting any amplified noise. The property adjoins a potential historic neighborhood adjacent to King William and a prominent multi-story loft is located across S. Alamo along S. Flores, residences that are well within the "sound shed" of amplified noise.

The King William Association has long opposed the use of amplified music along the S. Alamo/S. St. Mary's commercial corridors. One possible solution to the amplified noise issue is for the City of San Antonio (CoSA) to craft an ordinance restricting amplified music in mixed-use neighborhoods such as King William and Lavaca. Amplified noise, whether music or megaphone, certainly can be intrusive in the lives of those living in proximity to the commercial establishments. KWA has been fighting the amplified noise issue now for many years, especially on First Friday. Noise meters are of no real use; we have gone that route. Code Compliance is rarely in position to enforce the noise when it is excessive. Some action by CoSA would certainly be desirable from our neighborhood perspective.

Neighbors have expressed concern over tour buses and "pub-crawl" bikes. On May 31, KWA Executive Director Cherise Bell, Transportation Chair Rose Kanusky and I attended a meeting at the KWA office with Gary Gilmore of CoSA Ground Transportation, Karen Lindsey with City Sightseeing double decker busses, and Officer David McCall. Two residential neighbors were in attendance as well. The group wanted to express concerns about the use of amplification and inappropriate stops by the double decker busses on Guenther and S. Alamo Streets. The meeting was cordial and we feel some resolution was achieved. It was at this meeting, however, that KWA first learned of group cycle services being approved by city ordinance, and that the request was for three group cycle routes.

We do not recall group cycles being mentioned to us in conversation with Councilman's staff in February, and no local business or CoSA departments involved in the group cycles approval process ever contacted KWA for input. Group cycles are multiple carrying vehicles that can hold up to 15 passengers. Passengers can bring their own beer or wine, but the entertainment involves stopping at multiple bars along the way. According to the city ordinance for group cycles, they can only operate on commercial corridors in King William and cannot use amplified noise. Specific information for group cycles can be found city ordinance Chapter 33-Vehicles for Hire, Article III. Group Cycle Services.

However, King William has a no-open container ordinance in force, so the question is: Can the no-open container ordinance apply to the pub-crawl bike passengers? One response we received was that the group cycles are like limousines, which are exempt from no-open container ordinances. We continue to research this issue with CoSA.

As your president, I am most concerned about the trend of S. Alamo corridor becoming a bar strip. We continue to be stymied by zoning and grandfathering to prevent it. I thank you for all of your encouragement and positive comments as we continue to work on these important and sometimes daunting issues to preserve our neighborhood.



COORDINATORS Susan Athené,
Alan Cash, Bill Cogburn

LAYOUT Angela Martinez
MASTHEAD DESIGN
Roland Rodriguez
MASTHEAD CONCEPT Cherise Bell

Opinions expressed in this publication are those of the contributors and do not necessarily reflect the opinion(s) of the Board of Directors of the KWA. Editorial guidelines are available on-line at kingwilliamassociation.org.

KING WILLIAM ASSOCIATION
122 Madison St.
San Antonio, TX 78204
210-227-8786
info@ourkwa.org

OFFICE HOURS
Monday through Friday,
9 a.m. to 3 p.m.

ourkwa.org
kwfair.org
kingwilliamculturalartsdistrict.com

EXECUTIVE DIRECTOR
Cherise Bell
ADMINISTRATIVE ASSISTANT
Monika Perez-Moad
FAIR MANAGER Zet Baer
FAIR COORDINATOR Melanie Whitley

OFFICERS
PRESIDENT Harry Shafer
VICE PRESIDENT Jessie Simpson
TREASURER Beth Davis
SECRETARY Patrick Conroy
PARLIAMENTARIAN Josephine
Botello Garcia

BOARD OF DIRECTORS
Anne Alexander Charlotte Luongo
Shawn Campbell Monika Maeckle
Patricia Garcia Duarte Ethel Pedraza
Annice Hill Bradley Toland
Curtis Johnson Christine Viña

Advertising: Promote your business directly to your King William neighbors by advertising in this newsletter! Rates, sizes and details are on our website at kingwilliamassociation.org or call 227-8786, or email info@ourkwa.org.

© 2016 King William Association

King William Fair 2016 Wrap-Up

It's a wrap, folks! On May 26, we gathered up some of the 2016 King William Fair troops to Beethoven Maennerchor Halle und Garten and celebrated with those who dedicated their valuable time and incredible talents to make this the best Fair we have had to date!

Although the Fair had close to 1,000 volunteers, there were some exceptional people we wanted to reward for their commitment, experience and positive performances. We also wanted them to know that our community appreciates their efforts to preserve and enhance the King William Historic District. Neighboring businesses and those beyond our boundaries donated their services and products to recognize these amazing individuals.



2016 King William Fair Volunteers

Awards sponsored by Madhatters Tea House & Café:

Dave Fry - NuStar Energy Volunteer Coordinator and our Superstar with the Most Fiesta Spirit

Alan Cash - Finance Manager

Mario Garcia - UPS Golf Cart Drivers Volunteer Coordinator

Liz Monsivais - UPS Golf Cart Drivers Volunteer Coordinator and Sponsor



Awards sponsored by The Guenther House:

Sandi Cavazos - Frost Bank A-Team Coordinator, Art & Craft Booth Sitters

Joe and Mary Helen Mansbach - Compliance Managers

Eddie Romero - Beverage Manager

Richard Warren - Kids Kingdom Manager



Frank Hot Dogs, Cold Beer sponsored an award for **Phil Parsons** - Beverage Manager.

Awards sponsored by Rosarios Mexican Café Y Cantina:

Rudi Harst - Entertainment Manager

Annice Hill - Food Manager



Philip and Judy Dewey of **Windsongs** donated a handcrafted wind bell awarded to **Nancy and Chris Price** - Art and Craft Managers.



Our Volunteer of the Year award was sponsored by **Señor Veggie** and presented to **Sue Duffy** - Chief Parade Wrangler for the PAST TEN YEARS! Sue was also given a handcrafted glass art piece made by our neighbors at Garcia Art Glass.



Bliss Restaurant generously sponsored our award to **Brad Shaw**, who steadfastly served as the 2016 King William Fair Chair. Brad was also given a handcrafted glass art piece by Garcia Art Glass.



If you are interested in volunteering for King William Association events or sponsoring our mission to preserve the oldest historic district in the state of Texas and to promote the unique cultural heritage of San Antonio, please contact us at info@ourkwa.org.

- *Melanie Whitley, Fair Coordinator*

SAPD Central SAFFE Unit Contact Info

Main office: 207-7413

KW SAFFE Officers

on patrol:

Officer Robert Esquivel

Tel: 207-7413

Officer David McCall

Tel: 207-7413

Out in the Garden

with Alan Cash

Walks can be more enjoyable if you have a destination. Here are two. On the west side of the river, just north of Caesar Chavez Blvd. toward town, is a Texas Naturalist Wildscape Demonstration Garden. It has been there awhile, but with the good weather we've had, it is looking very good. It contains many native and adaptive plants that do well in San Antonio and South Texas. Many have tags giving the plant name and its growing habits. Take paper and pen because you may see something you want to add to your garden. The second destination is at 310 E. Arsenal between City St. and S. Main Ave. The home is a new addition to the neighborhood and the front garden is signed as a "Pollinator Habitat." Here also the plants are native and drought tolerant with the added benefit of attracting visitors such as bees and hummingbirds.

We have been fortunate to have had a moist, cool, and prolonged spring. Plants of all kinds are flourishing. Crepe myrtles seem to be blooming especially well, and they will provide color through a good part of the summer. If you have room to plant one of these versatile plants, please do. Crepe myrtles grow to various heights and have a variety of colors ranging from white, pink, dark red and lavender.

A FREE list of 50 types is available outside the KWA office on Madison St., to the right of the door. The list shows various characteristics of each type. An important thing to remember in selecting these, as any plant, is to put them where there is space for them to reach their mature size.

Because there are so many different types of crepe myrtles it may be hard to find the one you want. Two good local nurseries to check are Rainbow Gardens at 2585 Thousand Oaks, 494-6131, and Fanicks Nursery at 1025 Holmgreen Rd., 648-1303.

Many times I have mentioned plants that are well adapted to South Texas and are both drought tolerant and easy to grow. A picture is supposedly worth a thousand words, so I have come up with a kind of walking or driving tour of the King William neighborhood pointing out some of these great plants. All provide color in the garden over a long period and can be easily seen from the street. Most also attract hummingbirds, bees and butterflies. I hope you enjoy the "tour" and will add some of these plants to your garden.

1. 203 King William St. Thryallis. This is the shrub at the end of drive. It is perennial and should be cut back to about 6 inches high in late winter.

2. 523 King William St. Variegated ginger. It is just inside the front gate to the left in full sun. It is perennial and should be cut back in late winter.

3. 317 Madison. An orange lantana is at the end of the drive. There are many varieties of this easy-to-grow plant.

It also needs to be cut back in late winter. This may have been the plant they had in mind when saying some plants thrive on neglect. It needs about half a day's sun.

4. 337 Madison. A shady garden where the same variegated ginger at 523 King William is doing just as well with less light. The large plants that look like ferns are Sago Palms. They are evergreen and do just as well in the sun. They grow slow and make good pot plants.

5. 227 Wickes. Pride of Barbados. Lacy leafed plant with bright orange/red blooms. It should be cut back in late winter.

6. 619 Mission St. An orange blooming Esparanza at the curb. The yellow version is seen more often; should be cut back in late winter.

7. 631 Mission St. Fire Bush. This large plant at the curb with orange tubular flowers is a favorite of hummingbirds, bees and butterflies. Again, it is to be cut back in winter.

8. 103 W. Johnson St. Firecracker. Large spreading plant at the curb with bright red tubular flowers, another favorite of hummingbirds. Very hardy perennial, low maintenance and sun tolerant; may need cutting back after a hard freeze.

From *Wisdom of Mark Twain: A Book of Quotations*:
"Always do right. This will gratify some people, and astonish the rest."

Garden Note: Real gardens require patience, perseverance, experimentation and a sense of humor.

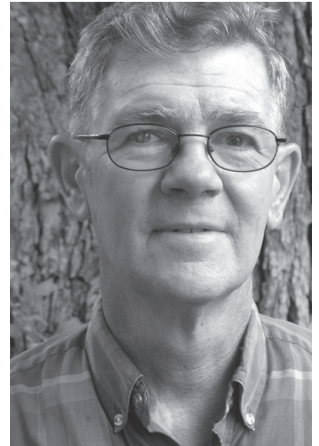

City Lights

After a day at the office that seemed to consist of nothing but twelve hours of meetings, I finally returned home and decided it was too late to start dinner preparations, fusing both practicality and sheer laziness in the same conclusion.

I suppose it's odd to find that the neighborhood I love so much for its special spirit and unique character is also evocative of so many other places I love. It looks so much like the Lower Garden District in the Crescent City, and has the same torpid languor in summer. It's possible to savor both the humidity and the heat if you aren't moving around too much.

But the commercial street that bisects the neighborhood reminds me of evenings in many warm climate places where dining and social life move outdoors of necessity in the summer. As soon as the sun begins to disappear, it's cooler outside than inside, aided by misting fans and the southeast breeze.

I took a seat at the long bar of a favorite establishment that looks as if a hurricane had blown it in from Miami's South Beach. It has a curvy Moderne feel to it down to the low wall at the sidewalk that divides diners from the evening promenade.

As far as I was concerned the bartender could take all night with the drink, and if the waiter never appeared, I wouldn't be unhappy. Just more time to savor the scene. The low light in the interior made it all the easier to appreciate the blue hue of dusk and the flotilla of animated diners in the safe harbor of the restaurant's garden, the candles on the tables like so many navigation lights in the marina. The picture was famed by the lace of tree canopies and twinkling lights suspended, apparently, from the sky.

I realized, like a Victorian stage, the scene was composed of layers, chattering couples in the foreground, the scrim of the windows in the middle ground, the terrace, slowly moving pedestrians beyond the wall, choreographed for act one, scene one, and drifting automobiles adding their head and tail lights to the impression of being by a canal instead of a street, cars moving as slowly as

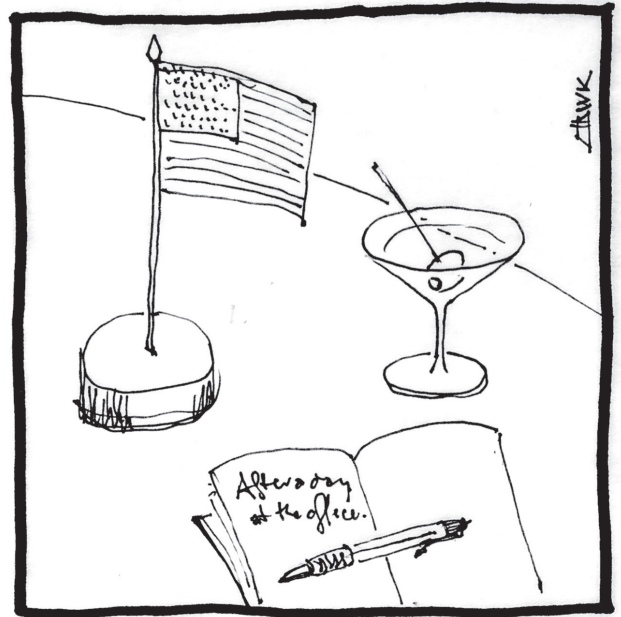

barges, but only to the left or right, like cardboard boats on a stage.

The thing I love most about this particular restaurant is that it doesn't have an architect's fingerprints on it, but is redolent of the owner's personality and taste. The staff complains that he never stops adding things, especially clever light fixtures that he apparently can't resist. Good for him. I live all day in a world of academically trained planners and architects. During the evening it's good to be reminded that our built environment is richer for having non-professionals contribute to it.

I'm glad that I could sit in an outdoor café and not feel the gnawing fear that all this peace could be shattered in an instant. At least I was until Orlando. Thinking of the Fourth of July, I'm glad I live in a place that still cherishes freedom of expression, the diversity that urban life provides, and open doors.

- Michael Guarino



Support the International Dark-Sky Association • darksky.org for more info

roland@berengena.com

Sidewalk Repair Programs Available to KW Residents

The City of San Antonio has started a Sidewalk Cost Sharing Program. Since the KWA is in a non-CDBG area, the city will pay for 50% of the cost to replace sidewalks. The City's program can be combined with the KWA's Sidewalk Program. The KWA will pay \$25 per linear foot to help King William residents to repair their sidewalks.

Here's how the process works:

1. Call 311 to request Sidewalk Cost Sharing Program and provide information to 311 operator.
2. Agree to estimated cost share amount.
3. Transportation and Capital Improvements (TCI) engineering staff completes field assessment and develops a detailed cost estimate within 10 days. (Note: City will only replace cracked portion of sidewalk.)
4. An invoice will be mailed to you; you have 15 days to accept or reject.
5. If the City's bid is accepted, you must complete a KWA sidewalk application and

turn it in to KWA office. You must have the KWA Sidewalk Chair's approval before contacting the City.

6. If you accept the City's bid, the City requires payment before the project is added to their project schedule.
7. All requests received will be completed within the City's fiscal year, which ends September 30, 2016.
8. Once the City has completed the project, you must notify the KWA and turn in a copy of the payment receipt. The KWA Sidewalk Chair will complete a site visit of the sidewalk, determine the amount of linear feet to calculate payment amount, and provide information to KWA staff to process a check.

For more information visit sanantonio.gov/TCI/Projects/SidewalkCost-SharingProgram, or come by the KWA office for a brochure. You may also contact me at 222-1586.

- Fred Pfeiffer
KWA Sidewalk Program Chair

KWA Investments

As directed by the KWA Board in 2014, the KWA Finance Committee began the task of developing a Statement of Investment Objectives, Policies and Management Guidelines (the "Statement"). The Statement was carefully crafted by the Finance Committee Investment Subcommittee over two years. The Subcommittee deliberately built a schedule to provide a generous amount of time to gather input, review, adapt and deliver the Statement to the Board for their consideration. The Board approved the Statement at the May 2015 meeting.

The primary guidelines are to:

- Provide financial stability through permanent funding of the KWA programmatic needs and philanthropic priorities
- Provide a clear understanding of the Fund's investment objectives, policies, and guidelines
- Seek a diversified investment strategy
- Obtain an investment advisor who will design an asset allocation appropriate for the Fund

At the March 2016 meeting, the Board approved the motion to direct the Finance Committee to select an investment firm, and subsequently invest the amount of approximately \$350,000. This amount was explained and discussed at the February Board meeting.

As of May 2016, funds in the amount of \$352,521 were invested with Merrill Lynch in accordance with the Statement.

- Beth Davis
KWA Board Treasurer

FINANCIAL COMMITMENT FOR SIDEWALK REPAIR DETACHED FROM CURB

50' Length, 4' Width = \$60 per linear ft.

LAND USE TYPE	CITIZEN SHARE	CITY SHARE	CITIZEN SHARE	CITY SHARE	TOTAL COST
RESIDENTIAL (NON-CDBG)	50%	50%	\$1,500	\$1,500	\$3,000
RESIDENTIAL (CDBG)	30%	70%	\$900	\$2,100	\$3,000

FINANCIAL COMMITMENT FOR SIDEWALK REPAIR ATTACHED TO CURB

50' Length, 4' Width = \$68 per linear ft.

LAND USE TYPE	CITIZEN SHARE	CITY SHARE	CITIZEN SHARE	CITY SHARE	TOTAL COST
RESIDENTIAL (NON-CDBG)	50%	50%	\$1,700	\$1,700	\$3,400
RESIDENTIAL (CDBG)	30%	70%	\$1,020	\$2,380	\$3,400

Area Developments Update

Hemisfair Park – Construction for the apartments should start December 2016 and be completed in roughly two years. Current plans are an eight story building with 168 units and a partial wrap-around parking garage with 410 spaces, including 238 for the general public. The southern façade will have a “green wall” (live plants growing up it).

Lone Star Brewery – Mike Fogel with Aqualand Development spoke at the June KWA general membership meeting. Fogel stated that construction for the mixed-use development will start next summer with fall 2018 as the projected completion date. They anticipate 200 to 250 units in the first phase, most likely apartments, with a mix of national and local retailers. Many of the original buildings will remain and they plan to have plenty of parking. Fogel also said that because the famous swimming pool does not have a filtration system, they do not plan on re-opening it.

San Pedro Creek – The City is currently working on creating a RIO (River Improvement Over) district with design guidelines for San Pedro Creek. Total project boundary goes from the highway near Columbus Street down south to the highway near W. La Chappelle St. Since S. Flores Street is the western boundary for the King William Association, the commercial buildings abutting S. Flores will be in RIO 7D. Construction to began on the north end first.

– Cherise Bell



San Pedro Creek Enhancements

Energy Retrofits for Historic Homes

Continued from page 1

ant barriers and evaluating the impact of this retrofit on reducing the energy use and utility costs of the home. Similar to the initial project, this study uses a mixture of energy use monitors and utility data analysis to evaluate the retrofit’s impact. Initial results from this study are expected by early 2017.

Visit ccs.utsa.edu for more details.

– Dr. Hazem Rashed-Ali, Associate Professor
Associate Dean of Research and Graduate Studies, UTSA

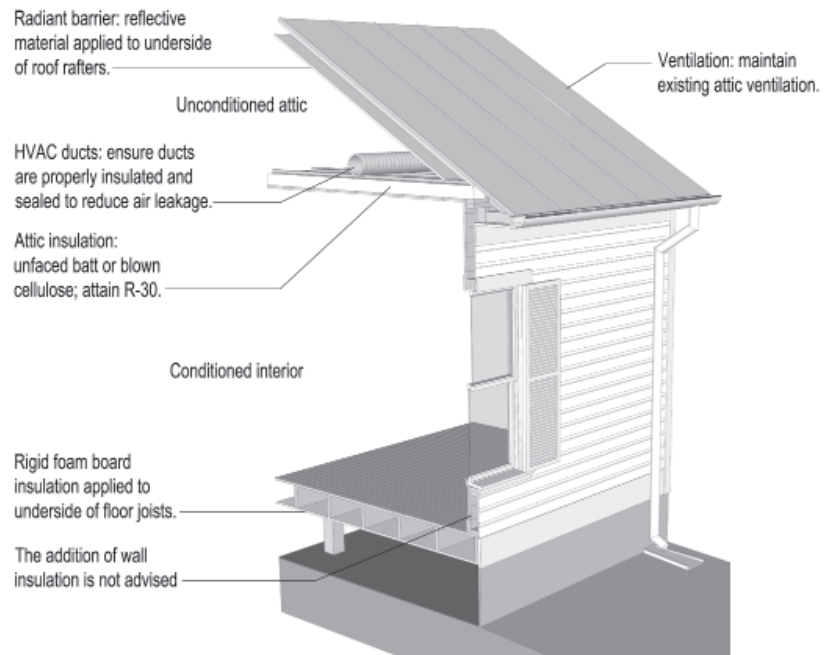

Primary retrofits recommended by the study include attic insulation, sealing of HVAC ducts, radiant barriers, weather stripping and attic ventilation.

New VIVA Bus Route

On June 6, VIA launched a new branded service called VIVA. The three lines that comprise the VIVA service include:

- **VIVA Culture** – direct connections to Southtown, King William, Downtown, Pearl and Broadway
- **VIVA Missions** – direct connections between the Alamo and the San Antonio Missions World Heritage Site
- **VIVA Centro** – connections between Centro Plaza and St. Paul Square

VIVA replaces the blue trolley line. For more information visit viainfo.net/BusService/VivaMain.aspx.

Selling the Neighborhood Since 1985!



NOW RESERVING!

1,852 SF to 2,848 SF



FALL 2017 Move-In!

Non-Condo Ownership Low HOAs



NEW! - Cedar Street Townhomes - Call for Info

www.KingWmRealty.com

(210) 225.0009 935 South Alamo, San Antonio, TX 78205



Stephen W. Yndo - Owner/Broker

ST. BENEDICT'S LOFTS King William Historic District



<< NEARLY 50% SOLD OUT >>

RESIDENTIAL + COMMERCIAL + LIVE/WORK
Available Units Starting at \$225,900



stblofts.com | 210.212.6900

Sales & Marketing exclusively by: LUX Agency, LLC - Broker



Garden St. School News

Bonham Academy has grown and continues to grow. The final stages of our school construction are less visible but just as important. The final phases will be the overhaul of the HVAC system in the gym and old building. Air conditioning is important in Texas!

Our State Commissioner of Education decided that there were so many flaws in the state assessment procedures this year that the mandatory retest for promotion would be cancelled and the requirement waived. Other requirements, such as summer school, remain in place. Perhaps we should do something differently the next time? I agree that our children need to be prepared to advance through school and on to successful and productive lives. We begin with the end in mind: the well-educated, productive citizen. How do we evaluate their knowledge, skills and talents? What have we learned so far and what do we need to do better? These are difficult questions.

At Bonham, we strive to educate the whole person, which is the child who comes to our school. We have a robust and thriving fine arts program that began in 1999 and has been supported by the King William Association for years. We have one of the only folclórico programs, taught as a regular part of every child's physical education class, in the state – also supported by our community. We have an outstanding theater program and venue – performances are “standing room only.” Many of these accomplishments, including teaching children in two languages, are difficult to quantify.

I want to take this opportunity to offer a hearty “thank you” to all the people in our community who help support our school in its mission to provide a unique and holistic educational opportunity for our children. We have children in dual-language, fine arts and advanced science programs due to the continued support and caring from all of you.

Enjoy these lazy days of July and the neighborhood we share.

- Principal William Webber



July – the quintessential month of summer vacation. In the third grade, I had to attend summer school in July, for penmanship. I earned a flat out ‘F’ during the school year. My handwriting was (and is) atrocious. My summer school teacher was also my Vacation Bible School and Sunday school teacher. I still have the book she gave me at the end of the session. I also remember quite clearly staring out the open window, since there was no air conditioning, and watching other children play outside while I made my circles and loops trying to improve my handwriting. When I first interviewed for a position as an administrator, one of the questions asked by the interview committee was if I had ever failed at anything and how I reacted to that failure. I was able to relate this story. I suppose someone out there has never failed at anything, but I am more inclined to think that everyone has tried and not mastered something, despite a valiant attempt.

You can't let your failures define you -- you have to let your failures teach you. You have to let them show you what to do differently the next time. – President Barack Obama



KWA Nominating Committee

At the May KWA Board meeting, as per the bylaws on nominating new board members, Harry Shafter appointed Patricia Duarte and Bradley Toland, Chair. At the June general membership meeting, the following members were nominated from the floor to be on the committee: Mary Ann Ohlenbusch, Nancy Price and Marita Emmett.

If you are an active, dues paid member, you may be getting a call from one of the nominating committee members, as six board positions are open. Board members serve one-year terms, up to three consecutive years.

Serving as a board member is an excellent way to get to know neighbors, learn about the many activities and changes occurring in King William, and be an advocate for our neighborhood.



A full service hospital helping your pet live a happy and healthy life.



210-534-4300

3608 S. Gevers @ Fair Ave. 78210
southeastanimalhospital.com

King William Fair 2016 Art & Craft Awards

Congratulations to the outstanding artists who won this year's Art and Craft awards! We had a wonderful group of talented artists, and it was challenging to make these selections. Thanks to all who participated in the 2016 King William Fair, and to Nancy and Chris Price who served as our volunteer Art and Craft Managers!



Best Fiesta Spirit: Emmanuel SA Artist, Martin Rangel

Martin Rangel was born in San Antonio and earned a Bachelor of Arts degree from the University of the Incarnate Word. Rangel is fascinated by iconic people and symbols of different generations throughout the past and present and how they evoke different meanings in different people. Images contained in his works include Mission San José, a bottle of Mexican Coke, the Virgin of Guadalupe, Bruce Lee, Diego Rivera and Frida Kahlo, just to name a few. Abstraction and representation, cultural and educational experiences, and his own personal foundations all blend in his mind, allowing Rangel to create works of art that bring an emotion or memory to viewers. To view his artwork, visit emmanuel.sa.com.

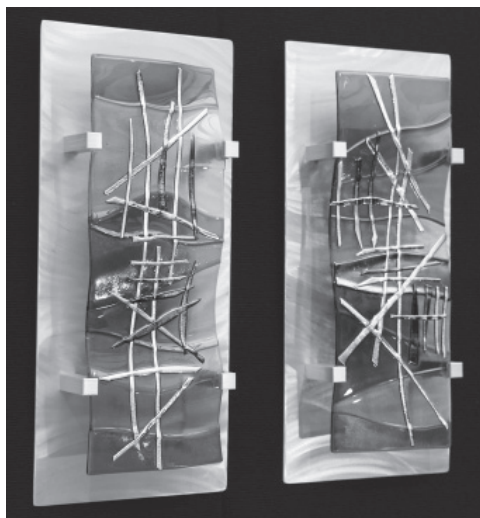

**Best Booth Display: Frank Thompson
Glass Art, Frank Thompson**

Frank Thompson is a self-taught, full-time glass artist with a working studio located north of Lake Charles, LA. He has been working in glass since 1982, and now works in 2D and

3D mixed media using glass and metal. His development of fused glass wall art is abstract in style and is influenced by the vibrant colors and positive energy of nature with a whimsical Caribbean theme. The result is a striking piece that reflects an illusion of movement and energy that intensifies when viewed from different angles with reflective light. Thompson currently shows and sells his work at juried art shows throughout the U.S. and at art galleries in Lake Charles and Lafayette. To see samples of his work, visit frankthompson.com.

Best in Show: Lashbrook Studios, Jennifer Lashbrook

Jennifer Lashbrook is a Dallas-based artist who earned her Bachelor of Fine Arts in Drawing and Painting from the University of North Texas, and has been working professionally for the last eight years. Although Lashbrook's oil paintings are impressive, she has become known for her "Swatch Paintings." This unique method of portraiture involves intricately cut pieces of paper arranged to create a stunning work of art. From a distance the works exhibit a photo realistic quality; upon closer inspection the viewer becomes mesmerized by the detailed and elaborate display of meticulously and cleverly arranged color swatches. These swatch paintings show a comical reference to the commercial, the digital and the reproducible, toying with the idea that anyone can create their own masterwork. To learn more, visit jenniferlashbrook.com.

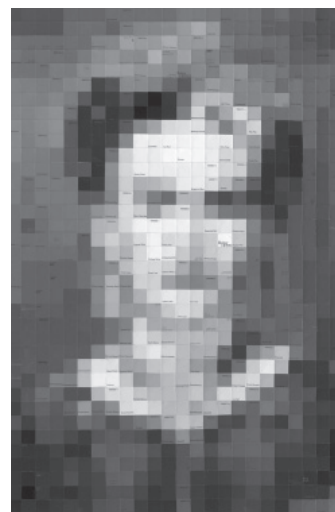

Honorable Mentions

- ◇ Splash Fine Art, Stella & Phillippe Coupe, splash-fineart.com
- ◇ Jus' Cuz Pottery, Al & Jeni Hoeksema, juscuzpottery.com
- ◇ Rewind Jewelry, Carlos Montanero & Crystal Rivera, rewindjewelry.com

Help us spread the word that artists can apply as an art and craft vendor for next year's Fair! Interested artists can contact me at melanie@kwfair.org to be placed on the artist's mailing list to be notified when applications open up next fall. For more pictures of the Art and Craft award winners, visit kwfair.org/art-craft.

- Melanie Whitley, Fair Coordinator



SAY Sí Presents: Stories Seldom Told: CORP/US

SAY Sí presents *Stories Seldom Told: CORP/US*, an exhibition that explores Corporate America and its role on our bodies.

With the annual *Stories Seldom Told* exhibition, SAY Sí student-artists are challenged to critically examine issues that they feel aren't being addressed in their everyday lives. After voting on a topic, the young artists are given three months to research and collaboratively create multimedia art installations that express the way they feel about that topic. In previous years, students have explored issues of race, class, mental health and poverty.

This year students chose to explore the impact of corporate America on our bodies. *Stories Seldom Told: CORP/US* will provoke audiences to consider how young people are affected by corporate entities. Young artists have created work that prompts viewers to discuss, re-evaluate and find a solution to the issues that we so often choose to ignore. Completed installations will transform the SAY Sí galleries into avant-garde spaces.

Stories Seldom Told: CORP/US exhibition opens Friday, July 1, 6:00 - 9:00 p.m. For more information, visit www.saysi.org.

- Stephen Guzman
SAY Sí Communications Manager



Panel participants, from left: Michele Monseau, Councilman Treviño, Anita Valencia, Irby Hightower, Ben McVey and Sylvia Benitez (Mark Hogensen not pictured).

Exhibition panel discussion - On June 3, Public Art San Antonio (PASA) held a panel discussion for the exhibition *Compositions in Space: Architectural Interventions* (April 14-June 14) that included three King William residents: artists Mark Hogensen and Michele Monseau, and architect Irby Hightower. The panel was moderated by District 1 Councilman Roberto Treviño. Along with the other artists in the exhibition, Anita Valencia, Ben McVey and Sylvia Benitez, Hightower, Hogensen and Monseau took part in the discussion of the work in the exhibition and how it interacts with space and architecture, and of the new PASA space in Plaza de Armas.

KWA 50th Anniversary Approaching

The King William Association was incorporated on July 28, 1967. This means that next year our organization will be 50 years old! We will be organizing a committee to create ways to celebrate and commemorate this important milestone, and volunteers are needed to help.

If you would like to volunteer for the 50th Anniversary Celebration Committee or have photos, documents or history regarding your house, the neighborhood or the organization that you would like to share, please contact the KWA office at 227-8786 or info@ourkwa.org.



MEMBERSHIP APPLICATION

September 2016 – August 2017

The King William Association invites you to join/renew your membership today! Your membership enables us to support local art, education, and community programs and to further our mission to preserve and maintain our historic and diverse neighborhood. Membership includes two wristbands to the King William Fair, a \$20 value.

Annual renewal dues for the 2016-2017 membership year must be paid ***before September 1st to vote at the Annual Meeting for the Board of Directors*** and by October 1st, in order to be listed in the annual KWA Directory. Contact the office at (210) 227-8786 or info@ourkwa.org if you have questions about membership.

A business or organization who is eligible for “active membership” (owns property within the KW Historic District), must inform in writing the Secretary of the KWA, the name and address of its representative who shall be entitled to cast its one vote at general membership meetings.

New Membership

Renewal Membership

I/We would like to activate/renew my/our King William Association membership at the level indicated below:

- Individual (\$20) Associate – *not a KW resident or property owner* (\$25) Family (\$25) Friend (\$40)
- Patron (\$50) Benefactor (\$100) Sustaining (\$250) Business–*ALL CAPS directory listing* (\$50)

I/We would like to be listed in the KWA Membership Directory as:

Business Name (for Business level): _____

Name(s): _____

Children’s Directory (under 18, list name): _____

Street: _____ City/State/Zip: _____

Primary Phone: _____ home cell work (please circle one)

Additional information for KWA database, KWA Eblast, and/or Business listings only:

Additional Phone Number(s): _____

E-mail Address(es): _____

Website Address (for Business level): _____

Let us know if you are interested in our KWA volunteer and committee opportunities:

- Architectural Advisory Board Member Finance Graffiti
- Home Tour King William Fair National Night Out Newsletter
- Cultural Arts Socials

Please mail or drop off this completed form with a check made payable to:

King William Association, 122 Madison Street, San Antonio, TX 78204

THANK YOU FOR YOUR SUPPORT!

OFFICE USE ONLY:

Date Rec'd _____ Paid \$ _____ Check # _____ Cash _____ Credit Card _____ BCAD/CC/MT _____

Time to Renew Your KWA Membership!

Frequently Asked Questions

Q – I have paid KWA membership dues before. Doesn't this last a lifetime?

A – You must renew your membership every year. KWA membership runs from September 1 to August 31 (not the calendar year).

Q – I just paid my full KWA dues in April before the Fair (I wanted to get my free wristbands). Why do I have to renew now?

A – Sorry, you just paid the full price of membership for just about one-third of the membership year. You could have enjoyed a whole year of membership benefits (including your free wristbands).

Q – Too complicated! How do I keep up with this?

A – Look at the membership card you received when you joined – there is an expiration date on it. We also remind you in the newsletter (like this one) and in e-blasts. And a new membership card is mailed to you every year – as long as you renew your membership.

Q – I joined early last membership year – sometime in early October, I think. But my name and address were not in the Membership Directory. What's with that?

A – You must renew your membership by October 1 to be listed in the directory. We must have a cut-off date in order to have time to print and mail the directories.

Q – I hate mailing in dues and who does that anymore, anyway? This is the 21st century! And it is too hot now to walk down to the KWA office. And gas is too high to drive there. Why do you make membership so complicated?

A – You mentioned a new century! Welcome. You can now renew your membership ONLINE at www.ourkwa.org.

Q – So, I know I get free wristbands for the KW Fair if I am a KWA member, but what else is in it for me?

A – Glad you asked:

- You can stay engaged and informed on issues that affect our neighborhood through committee/board memberships, newsletters, e-blasts and general membership socials.
- You will have lots of opportunities to contribute your talents for volunteer work in the 'hood – it really is fun!
- You get to brag to your friends about being a supporter of the arts, education and community programs that preserve and maintain our historic, diverse and residential neighborhood.
- You get membership discounts on KW Fair merchandise.
- You get discounts from many restaurants and businesses in the 'hood just by showing that little membership card.
- And yes, every KWA member gets two free Fair wristbands!

- Annice Hill, Membership Chair

Beyond Vision Loss

Hope, Help, Independence

Visual impairment is an ever-increasing health issue and the leading reason for loss



of independent living among older Americans. Where can they turn for non-medical help? What can they do to maintain independence? How can they stay connected with the community? The Low Vision Resource Center (LVRC), which just celebrated its 19th anniversary, can help. The LVRC offers two major programs for visually impaired people in the San Antonio area: the San Antonio Low Vision Club and Owl Radio.

The San Antonio Low Vision Club (lowvisionclub.org) focuses on support, information, independent living, and social opportunities. The Club schedules monthly programs to keep its 900+ members informed about medical research into eye disease, identifies local resources that can assist them, and arranges social activities such as bingo, bowling, games day, and a Christmas party. The Club also assists with the formation of support groups and sponsors an annual Low Vision EXPO where attendees can learn about the products and services available in San Antonio and surrounding cities.

Owl Radio (owlradio.org) addresses the loss of independence and sense of isolation caused by the inability to read printed material. Owl Radio provides live daily radio broadcasts of the *San Antonio Express-News* and other newspapers, as well as recorded programs of national publications. More than 3,100 radios have been distributed in the San Antonio area.

For more information about either of these programs, please visit the websites listed above or call 829-4223.

- Bill Phelps, Executive Director



122 Madison St.
San Antonio, Texas 78204

NON PROFIT ORG.
US POSTAGE
PAID
SAN ANTONIO,
TEXAS
PERMIT N°. 3321

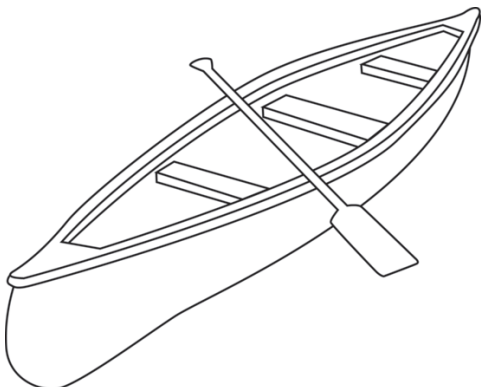

July Calendar

- 4 Summer Social - Upper Mill Park - 11:00 a.m.
- 12 Deadline for August newsletter
- 20 KWA Board Meeting - 6:30 p.m.