

Virgin  
HOTELS  
LAS VEGAS

Virgin  
HOTELS







“

VIRGIN HOTELS  
WILL PAINT  
THE TOWN RED

”

- Sir Richard Branson

OPENING FALL 2020



A modern hotel lobby with large glass windows, textured columns, and indoor plants. The space is bright and open, with a red accent wall and a white ceiling with hanging greenery. The floor is made of light-colored stone tiles. The text "RE-IMAGINED" is overlaid on the bottom left.

RE-IMAGINED

A LAS VEGAS LIFESTYLE HOTEL  
WITH INNOVATIVE DESIGN AND  
EXCEPTIONAL FUNCTIONALITY





# FIRST IMPRESSIONS

THE CLEAR SENSE OF ARRIVAL

EMPHASIZES THE DESERT RESORT EXPERIENCE





# MODERN DESERT OASIS

VIBRANT, DYNAMIC EVENT AND  
ENTERTAINMENT SPACES





*Virgin*  
HOTELS  
LAS VEGAS

CURIO COLLECTION  
by Hilton

A PROUD PARTNER OF HILTON'S ELITE CURIO COLLECTION

FEATURING ALL OF THE BENEFITS OF HILTON HONORS AND MEETING PLANNER LOYALTY PROGRAMS





EXCEPTIONALLY APPOINTED

1,504 CHAMBERS, GRAND CHAMBERS AND PENTHOUSE SUITES

WITH VIRGIN HOTELS ERGONOMICALLY DESIGNED

PATENTED BED AND HILTON'S IN-ROOM TECHNOLOGY



# HIGH-POWERED OUTDOOR EVENTS

FIVE ACRES OF LUXE OUTDOOR SPACES  
WITH UNLIMITED POSSIBILITIES







# COMMONS CLUB

CAPTIVATING AND EXHILARATING LOUNGES AND BARS





NETWORK

SIGNATURE HIDEAWAYS THAT SPARK PROFESSIONAL CONNECTIONS





# CONNECTED

130,000 SQUARE FEET OF EXPANSIVE INDOOR, OUTDOOR EVENT AND MEETING SPACES,  
TURNING THE ORDINARY INTO THE EXTRAORDINARY



A man in a black t-shirt and dark pants is rappelling down a rope from a high ceiling structure in a large arena. The arena is filled with a large crowd of people, many of whom have their hands raised in the air, cheering and taking photos. The lighting is dramatic, with blue spotlights illuminating the man and the crowd. The ceiling is a complex metal truss structure with various lights and equipment.

# HEARTBEATS RACE

IN THE 3,800 PERSON MULTI-USE STATE OF THE ART THEATRE





# NOTEWORTHY

JUST MINUTES TO

MCCARRAN INTERNATIONAL AIRPORT

—

THE LAS VEGAS CONVENTION CENTER

—

AND THE LAS VEGAS STRIP

FOR SALES AND INFORMATION

[SALES.LASVEGAS@VIRGINHOTELS.COM](mailto:SALES.LASVEGAS@VIRGINHOTELS.COM)

1-855-693-5500



## ARTIST HALL

28,512 SQUARE FEET | 294' X 106' | CEILING HEIGHT 18' - 22'

**A**  
SQUARE FEET: 9,205  
SIZE: 102' X 106'

**B**  
SQUARE FEET: 6,740  
SIZE: 67' X 100'

**C, H**  
SQUARE FEET: 2,685  
SIZE: 53' X 44'

**D - F**  
SQUARE FEET: 1,800  
SIZE: 35' X 44'

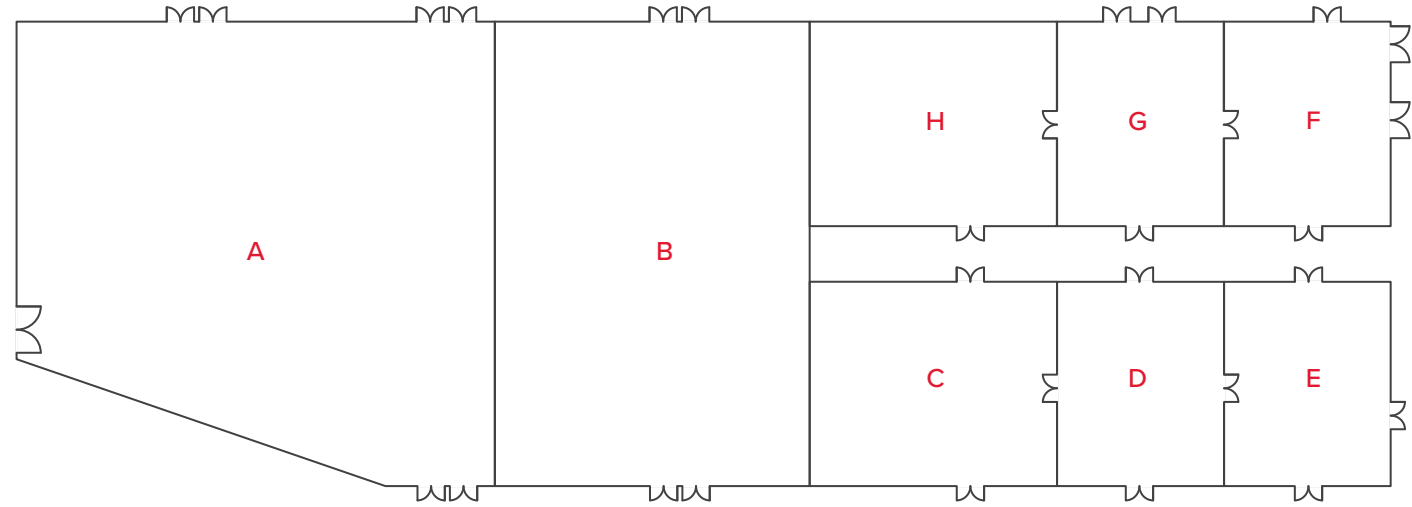

← PARADISE SELF PARKING

↓ PARADISE TOWER

PRE-FUNCTION

↓ CASINO TOWER

## MUSE HALL

15,720 SQUARE FEET | 131' X 120' | CEILING HEIGHT 20'

**A - D, F - I**  
SQUARE FEET: 810  
SIZE: 30' X 27'

**E**  
SQUARE FEET: 1,560  
SIZE: 52' X 30'

SQUARE FEET: 4,860  
SIZE: 52' X 90'

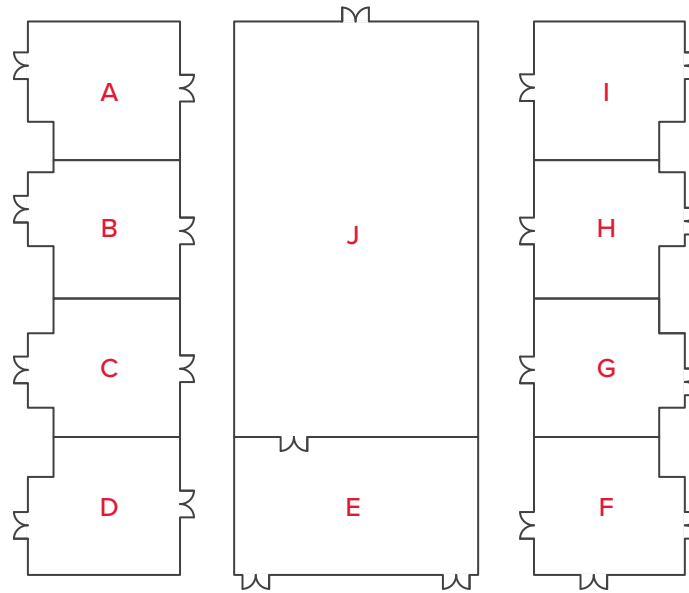

PRE-FUNCTION

↓ CASINO ACCESS

## THE JOINT

29,374 SQUARE FEET | 294' X 106' | CEILING HEIGHT UP TO 49'

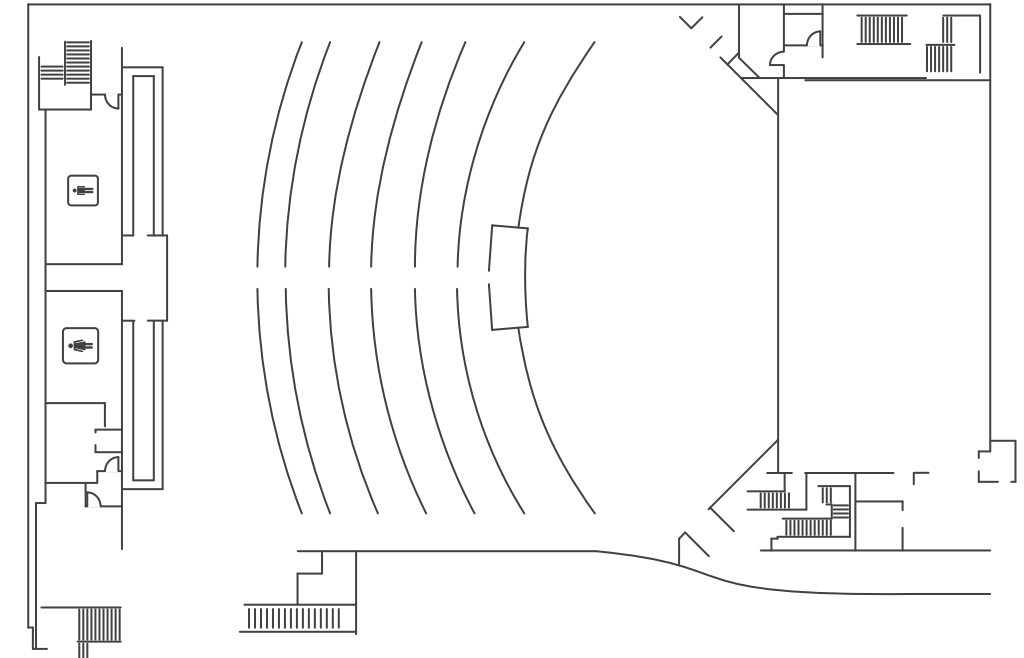

PRE-FUNCTION

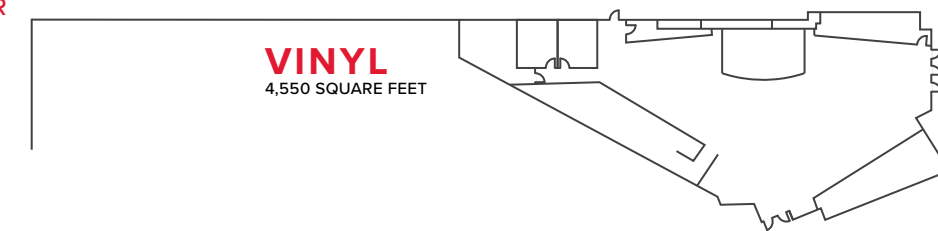

**VINYL**  
4,550 SQUARE FEET

## STUDIO BOARDROOMS

800 SQUARE FEET | 28' X 29' | CEILING HEIGHT UP TO 8'

PARADISE TOWERS  
FLOORS 3&4

## STUDIO MEETING ROOMS

338 SQUARE FEET | 13' X 26' | CEILING HEIGHT UP TO 8'

PARADISE TOWERS  
FLOORS 3&4

VENUE	Theater	Classroom 4 per 8'	Rounds of 10	Crescent Rounds of 8	Cocktail Reception	10x10 Expo	8x10 Expo
<b>ARTIST HALL</b>	2400+	1500	1500	1200	3000	116	172
A	680	570	520	416	700	38	46
B	500	420	400	320	500	30	36
C,H	220	150	120	96	200	Varies	Varies
D, E, F, G	100	80	70	56	100	Varies	Varies
A & B COMBINED	1180	980	920	736	1200	64	77
E & F OR D & G COMBINED	300	240	220	176	250	Varies	Varies
C & H COMBINED	440	340	300	240	400	24	32
C,D,E OR F,G,H COMBINED	460	320	280	224	420	N/A	N/A
C,D,E,F,G,H COMBINED	1000	700	580	464	1100	72	90
C,D,G,H COMBINED	700	540	460	368	500	Varies	Varies
D,E,F,G COMBINED	600	480	400	320	450	Varies	Varies
<b>MUSE HALL</b>	1500+	1040	900	576	1150	84	110
A,B,C,D, F, G, H, I	50	32	40	32	50	N/A	N/A
E	108	48	80	64	90	N/A	N/A
J	456	180	280	224	300	N/A	N/A
(2) SECTIONS	120	80	80	64	100	Varies	Varies
(3) SECTIONS	252	128	146	102	150	Varies	Varies
MUSE E & J	700	400	360	256	400	Varies	Varies

\*ROOM AND AUDIO VISUAL SET(S) MAY IMPACT CAPACITY

VENUE	Theater	Classroom 4 per 8'	Conference	Hollow Square	U-Shape	Rounds of 10	Crescent Rounds of 8	Cocktail Reception
<b>FESTIVAL HALL</b>	561	360	N/A	N/A	N/A	320	250	375
A	154	108	38	42	36	80	64	100
B	154	108	38	42	36	80	64	100
C	154	108	38	42	36	80	64	100
A&B OR B&C	374	216	N/A	N/A	N/A	200	120	200
<b>THE STUDIO COLLECTION</b>								
STUDIO D, F, G	N/A	N/A	14	N/A	N/A	N/A	N/A	N/A
STUDIO A, B, C, E	50	32	16	24	20	40	32	40
<b>VINYL</b>	250	84	N/A	N/A	N/A	150	120	400
<b>JOINT</b>	2730	800	N/A	N/A	N/A	660	528	3850
MAIN FLOOR	1769	800	N/A	N/A	N/A	660	528	Varies
VIP LEVEL	201	N/A	N/A	N/A	N/A	N/A	N/A	Varies
BALCONY	760	N/A	N/A	N/A	N/A	N/A	N/A	Varies

## FESTIVAL HALL

6,000 SQUARE FEET | 100' X 60'  
CEILING HEIGHT UP TO 19'

**A - C**  
SQUARE FEET: 2,000  
SIZE: 60' X 33'

