

SALINAS VALLEY FAIR

May 16 – 19, 2019

625 Division Street, King City, CA 93930

831-385-3243 FAX 831-385-3345

Contact - Cindy Escobar E-mail address: ce@salinasvalleyfair.com

COMMERCIAL EXHIBIT APPLICATION

***\$10.00 Non Refundable Application Fee due per application (before 3/16/19) ***

****\$25.00 Non Refundable Application Fee due per application received after 3/16/19****

Company Name: _____

Owners Name: _____

Mailing Address: _____

City: _____ State _____ Zip Code _____

Phone: _____ Cell Phone _____

E-mail address _____

St. Board of Equalization # _____

Give away product or drawing? _____ If so, describe item(s) _____

Offer free food samples(s) _____ If so, describe item(s) _____

Use Sound Devices or Pitch Products (TV, Radio, PA, etc) _____

Require use of water? _____ If so, describe _____

Please list all products & prices of items you would like to sell: (add attached sheet if needed)

Prices for exhibit spaces: Pipe & drape provided for inside spaces only-No Canopies provided.

- ALL Indoor Space is located in Pavilion Building – See map on next page

******PLEASE INDICATE INDOOR OR OUTDOOR SPACE & SIZE REQUIRED******

Outdoor Space: 10'x10' - \$350; 10'x 20' - \$450; 10'x30' - \$575

Outdoor space to be assigned by Manager.

Amount of space needed _____

Indoor Space: 10'x10' in-line-\$375; 10'x10' corner-\$400; 10'x 15' wall-\$425

Amount of space needed _____ (have only 3 - 10'x15')

Booth Space Choice - 1st Choice # _____ 2nd Choice # _____ 3rd Choice # _____

No guarantee that your space choice will be available. Adjoining 10' x 10' will be a fee of \$200

Electrical: Requirements & Costs for run of Fair: Volt/Amp/Watt Required _____

Special Electrical Needs _____

_____ **1 - 20 AMPS - \$50.00** _____ **21 - 50 AMPS-\$150.00** _____ **51-100 AMPS-\$250**

Fair does not provide extension cords, cord caps or other equipment required.

RV/Stock Truck/Dead Storage Requirements: If RV, Stock truck or dead storage is needed, please indicate type and amount of space needed for each.

RV _____ \$300/week _____ Stock Truck-\$50/week _____ Dead Storage _____

GENERAL LIABILITY INSURANCE: Each exhibitor must provide the Salinas Valley Fair with Proof of general liability insurance of no less than \$1,000,000.

___ My own carrier Carrier Name _____

___ WFA Master List CFSA # _____ Policy Expires _____ Name policy is under _____

___ Purchase Insurance through Fair

WORKER'S COMPENSATION INSURANCE: - Each exhibitor who hires employees must also provide a copy of their worker's compensation insurance.

**PAVILION BUILDING (INDOOR SPACE) DIAGRAM
(not to scale – sample only)**

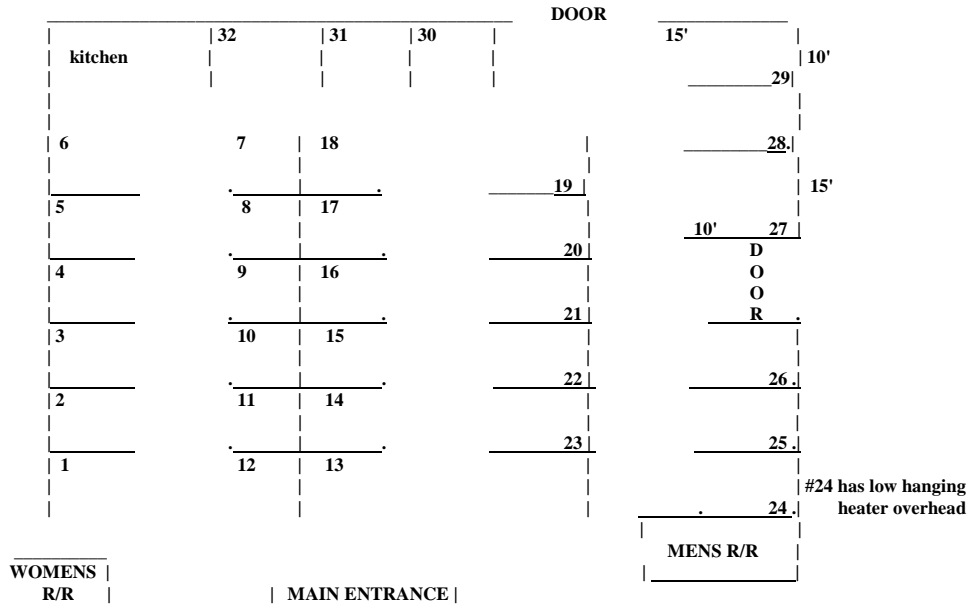

#26, 27 & 29 are 10' x 15' and the rest are 10' x 10' spaces
#19, 20, 21, 22, 23 will have only 3' dividers - no 8' back

Deadline for application is March 16, 2019

We will continue to take applications for a wait list until May 1, 2019.

REMEMBER

- 1. A \$10.00 non-refundable Application Fee is due per application received before March 16, 2019.**
- 2. \$25.00 Non Refundable Application Fee per application received after March 16, 2019 deadline.**
- 3. You are required to send picture of booth space with application.**
- 4. Return application to address, e-mail or fax on 1st page.**
- 5. SEND APPLICATION & application fee ONLY!! Do Not send space rental fee**

IF APPLICATION IS APPROVED, SVF WILL SEND YOU A CONTRACT & YOU CAN SEND THE SPACE RENTAL FEES WITH THE SIGNED CONTRACT.